



# BUCCAL TUBES & MOLAR BANDS

TRUFIT™ 2.0

TRUEASE™

VOTION®

TRUCAST™

- TruFit™ 2.0 \_\_\_\_\_ P. 55-67
- Bondable Buccal Tubes \_\_\_\_\_ P. 55-57
- Weldable Buccal Tubes \_\_\_\_\_ P. 58-59
- Molar Bands \_\_\_\_\_ P. 60
- Prewelded Band & Tube Assemblies \_\_\_\_\_ P. 61-64
- Prewelded Band & Tube Assembly Starter Kits \_\_\_\_\_ P. 65
- Molar Band Conversion Chart \_\_\_\_\_ P. 66-67
- Prewelded & Bondable Lingual Attachments \_\_\_\_\_ P. 68
- TruEase™ Bondable Buccal Tubes \_\_\_\_\_ P. 70
- Votion® Bondable Buccal Tubes \_\_\_\_\_ P. 71
- TruCast™ Bondable Buccal Tubes \_\_\_\_\_ P. 72



# TruFit™ 2.0

## Bondable Maxillary Buccal Tubes

- Available in the most popular prescriptions
- The first molar gingival ball hooks hold elastics and springs securely
- Designed with the latest technology for patient comfort

**Improved Low-Profile Design**  
Reduces occlusal interference

**Anatomical Design**  
Conforms to the tooth

**80 Gauge Mesh Pad**  
For improved bond adhesion

**Smooth and Rounded Hooks**  
For maximum patient comfort

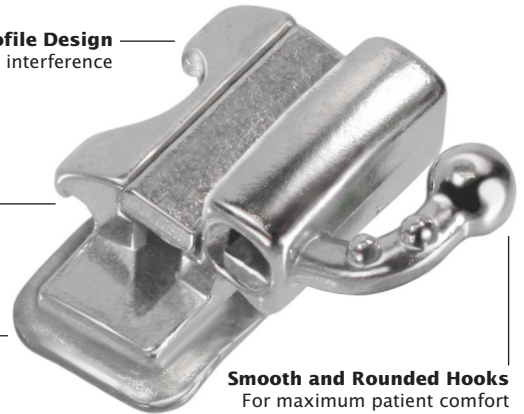

**Maxillary Single Convertible**



**Maxillary Double Convertible**  
.018" x .025" Auxiliary Tube

	Slot Torque	Distal Offset	Headgear Tube	Slot Size	Bondable	
					Left	Right
<b>R</b>	-10°	+10°	-	.018"	492-11-2610	492-11-1610
	-10°	+10°	-	.022"	492-12-2610	492-12-1610
<b>R</b>	-14°	+14°	-	.018"	492-91-2610	492-91-1610
	-14°	+14°	-	.022"	492-92-2610	492-92-1610
<b>M</b>	-14°	+10°	-	.018"	492-21-2610	492-21-1610
	-14°	+10°	-	.022"	492-22-2610	492-22-1610
1 pack (10 tubes)						

	Slot Torque	Distal Offset	Headgear Tube	Slot Size	Bondable	
					Left	Right
<b>R</b>	-10°	+10°	-	.018"	492-11-2631	492-11-1631
	-10°	+10°	-	.022"	492-12-2631	492-12-1631
<b>R</b>	-14°	+14°	-	.018"	492-91-2631	492-91-1631
	-14°	+14°	-	.022"	492-92-2631	492-92-1631
1 pack (10 tubes)						



**Maxillary Combination Convertible**  
Gingival Headgear Tube



**Maxillary Combination Convertible**  
Occlusal Headgear Tube

	Slot Torque	Distal Offset	Headgear Tube	Slot Size	Bondable	
					Left	Right
<b>R</b>	-10°	+10°	.045"	.018"	492-11-2671	492-11-1671
	-10°	+10°	.045"	.022"	492-12-2671	492-12-1671
<b>R</b>	-14°	+14°	.045"	.018"	492-91-2671	492-91-1671
	-14°	+14°	.045"	.022"	492-92-2671	492-92-1671
<b>M</b>	-14°	+10°	.045"	.018"	492-21-2671	492-21-1671
	-14°	+10°	.045"	.022"	492-22-2671	492-22-1671
1 pack (10 tubes)						

	Slot Torque	Distal Offset	Headgear Tube	Slot Size	Bondable	
					Left	Right
<b>R</b>	-10°	+10°	.045"	.018"	492-11-2672	492-11-1672
	-10°	+10°	.045"	.022"	492-12-2672	492-12-1672
<b>R</b>	-14°	+14°	.045"	.018"	492-91-2672	492-91-1672
	-14°	+14°	.045"	.022"	492-92-2672	492-92-1672
<b>M</b>	-14°	+10°	.045"	.018"	492-21-2672	492-21-1672
	-14°	+10°	.045"	.022"	492-22-2672	492-22-1672
<b>S</b>	0°	0°	.045"	.018"	492-51-2672	492-51-1672
	0°	0°	.045"	.022"	492-52-2672	492-52-1672
1 pack (10 tubes)						

**R** The Ortho Technology version of the Roth Rx\*

**M** The Ortho Technology version of the McLaughlin, Bennett, & Trevisi Rx\*

**S** Standard Edgewise Rx

\*The Ortho Technology versions of these prescriptions are not implied to be an exact version of any other system, nor do we claim any endorsement of the respective doctors.

© 2018 Ortho Technology, Inc. TruFit is a trademark of Ortho Technology. Due to our ongoing efforts to update and improve our buccal tube designs, the product you receive may vary slightly from those depicted. †Bases are non-etched.

# BUCCAL TUBES



Buccal Tubes



## Maxillary Triple Convertible

Occlusal Headgear Tube  
.018" x .025" Auxiliary Tube

	Slot Torque	Distal Offset	Headgear Tube	Slot Size	Bondable	
					Left	Right
<b>R</b>	-10°	+10°	.045"	.018"	492-11-2652	492-11-1652
	-10°	+10°	.045"	.022"	492-12-2652	492-12-1652
<b>R</b>	-14°	+14°	.045"	.018"	492-91-2652	492-91-1652
	-14°	+14°	.045"	.022"	492-92-2652	492-92-1652
<b>M</b>	-14°	+10°	.045"	.018"	492-21-2652	492-21-1652
	-14°	+10°	.045"	.022"	492-22-2652	492-22-1652
1 pack (10 tubes)						



## Maxillary Combination Non-Convertible

Occlusal Headgear Tube

	Slot Torque	Distal Offset	Headgear Tube	Slot Size	Bondable	
					Left	Right
<b>R</b>	-10°	+8°	.045"	.018"	492-11-2682	492-11-1682
	-10°	+8°	.045"	.022"	492-12-2682	492-12-1682
<b>S</b>	0°	0°	.045"	.018"	492-51-2682	492-51-1682
	0°	0°	.045"	.022"	492-52-2682	492-52-1682
1 pack (10 tubes)						



## Maxillary 1st or 2nd Molar Single Non-Convertible

	Slot Torque	Distal Offset	Headgear Tube	Slot Size	Bondable	
					Left	Right
<b>R</b>	-10°	+8°	-	.018"	-	-
	-10°	+8°	-	.022"	-	-
<b>R</b>	-10°	+10°	-	.018"	492-11-2020	492-11-1020
	-10°	+10°	-	.022"	492-12-2020	492-12-1020
<b>R</b>	-14°	+14°	-	.018"	492-91-2020	492-91-1020
	-14°	+14°	-	.022"	492-92-2020	492-92-1020
<b>M</b>	-14°	+10°	-	.018"	492-21-2020	492-21-1020
	-14°	+10°	-	.022"	492-22-2020	492-22-1020
<b>S</b>	0°	0°	-	.018"	492-51-2020	492-51-1020
	0°	0°	-	.022"	492-52-2020	492-52-1020
1 pack (10 tubes)						

Bondable	
Left	Right
492-11-2023	492-11-1023
492-12-2023	492-12-1023
-	-
-	-
-	-
492-21-2023	492-21-1023
492-22-2023	492-22-1023
492-51-2023	492-51-1023
492-52-2023	492-52-1023

**R** The Ortho Technology version of the Roth Rx\*

**M** The Ortho Technology version of the McLaughlin, Bennett, & Trevisi Rx\*

**S** Standard Edgewise Rx



\*The Ortho Technology versions of these prescriptions are not implied to be an exact version of any other system, nor do we claim any endorsement of the respective doctors.



## Bondable Mandibular Buccal Tubes



**Mandibular 1st or 2nd Molar Single Non-Convertible**

	Slot Torque	Distal Offset	Headgear Tube	Slot Size	Bondable	
					Left	Right
<b>R</b>	-25°	+5°	-	.018"	-	-
	-25°	+5°	-	.022"	-	-
<b>R</b>	-25°	+4°	-	.018"	492-91-4020	492-91-3020
	-25°	+4°	-	.022"	492-92-4020	492-92-3020
<b>M</b>	-10°	0°	-	.018"	492-21-4020	492-21-3020
	-10°	0°	-	.022"	492-22-4020	492-22-3020
<b>S</b>	0°	0°	-	.018"	492-51-4020	492-51-3020
	0°	0°	-	.022"	492-52-4020	492-52-3020
1 pack (10 tubes)						

Bondable	
Left	Right
492-11-4023	492-11-3023
492-12-4023	492-12-3023
-	-
-	-
492-21-4023	492-21-3023
492-22-4023	492-22-3023
492-51-4023	492-51-3023
492-52-4023	492-52-3023

### TruFit 2.0 Bases



**1 Rectangular Base**

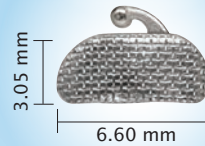

**2 Large Base**



**3 Short Base**

Buccal Tubes



**Mandibular Lip Bumper Convertible Gingival Tube**

	Slot Torque	Distal Offset	Headgear Tube	Slot Size	Bondable	
					Left	Right
<b>R</b>	-25°	+4°	.045"	.018"	492-91-4691	492-91-3691
	-25°	+4°	.045"	.022"	492-92-4691	492-92-3691
1 pack (10 tubes)						



**Mandibular Double Convertible**  
.018" x .025" Auxiliary Tube

	Slot Torque	Distal Offset	Headgear Tube	Slot Size	Bondable	
					Left	Right
<b>R</b>	-25°	+4°	-	.018"	492-91-4631	492-91-3631
	-25°	+4°	-	.022"	492-92-4631	492-92-3631
<b>M</b>	-20°	0°	-	.018"	492-21-4631	492-21-3631
	-20°	0°	-	.022"	492-22-4631	492-22-3631
1 pack (10 tubes)						



**Mandibular Single Convertible**

	Slot Torque	Distal Offset	Headgear Tube	Slot Size	Bondable	
					Left	Right
<b>R</b>	-25°	+4°	-	.018"	492-91-4610	492-91-3610
	-25°	+4°	-	.022"	492-92-4610	492-92-3610
<b>M</b>	-20°	0°	-	.018"	492-21-4610	492-21-3610
	-20°	0°	-	.022"	492-22-4610	492-22-3610
1 pack (10 tubes)						

© 2018 Ortho Technology, Inc. TruFit is a trademark of Ortho Technology. Due to our ongoing efforts to update and improve our buccal tube designs, the product you receive may vary slightly from those depicted.

# TruFit™ 2.0

Prewelded free of charge  
on TruFit 2.0 Molar Bands  
See page 60

- Available loose or prewelded
- 3.5 mm mesial/distal measurement

## Weldable Buccal Tubes



**Maxillary  
Single Convertible**

	Slot Torque	Distal Offset	Headgear Tube	Slot Size	Weldable	
					Left	Right
<b>R</b>	-10°	+10°	-	.018"	490-11-2610	490-11-1610
	-10°	+10°	-	.022"	490-12-2610	490-12-1610
<b>R</b>	-14°	+14°	-	.018"	490-91-2610	490-91-1610
	-14°	+14°	-	.022"	490-92-2610	490-92-1610
<b>M</b>	-14°	+10°	-	.018"	490-21-2610	490-21-1610
	-14°	+10°	-	.022"	490-22-2610	490-22-1610
1 pack (10 tubes)						



**Maxillary  
Combination Convertible  
Gingival Headgear Tube**

	Slot Torque	Distal Offset	Headgear Tube	Slot Size	Weldable	
					Left	Right
<b>R</b>	-10°	+10°	.045"	.018"	490-11-2671	490-11-1671
	-10°	+10°	.045"	.022"	490-12-2671	490-12-1671
<b>R</b>	-14°	+14°	.045"	.018"	490-91-2671	490-91-1671
	-14°	+14°	.045"	.022"	490-92-2671	490-92-1671
<b>M</b>	-14°	+10°	.045"	.018"	490-21-2671	490-21-1671
	-14°	+10°	.045"	.022"	490-22-2671	490-22-1671
1 pack (10 tubes)						



**Maxillary  
Double Convertible**  
.018" x .025" Auxiliary Tube

	Slot Torque	Distal Offset	Headgear Tube	Slot Size	Weldable	
					Left	Right
<b>R</b>	-10°	+10°	-	.018"	490-11-2631	490-11-1631
	-10°	+10°	-	.022"	490-12-2631	490-12-1631
<b>R</b>	-14°	+14°	-	.018"	490-91-2631	490-91-1631
	-14°	+14°	-	.022"	490-92-2631	490-92-1631
1 pack (10 tubes)						



**Maxillary 1st or  
2nd Molar Single  
Non-Convertible**

	Slot Torque	Distal Offset	Headgear Tube	Slot Size	Weldable	
					Left	Right
<b>R</b>	-10°	+10°	-	.018"	490-11-2020	490-11-1020
	-10°	+10°	-	.022"	490-12-2020	490-12-1020
<b>R</b>	-14°	+14°	-	.018"	490-91-2020	490-91-1020
	-14°	+14°	-	.022"	490-92-2020	490-92-1020
<b>M</b>	-14°	+10°	-	.018"	490-21-2020	490-21-1020
	-14°	+10°	-	.022"	490-22-2020	490-22-1020
<b>S</b>	0°	0°	-	.018"	490-51-2020	490-51-1020
	0°	0°	-	.022"	490-52-2020	490-52-1020
1 pack (10 tubes)						



**Maxillary  
Combination Convertible  
Occlusal Headgear Tube**

	Slot Torque	Distal Offset	Headgear Tube	Slot Size	Weldable	
					Left	Right
<b>R</b>	-10°	+10°	.045"	.018"	490-11-2672	490-11-1672
	-10°	+10°	.045"	.022"	490-12-2672	490-12-1672
<b>R</b>	-14°	+14°	.045"	.018"	490-91-2672	490-91-1672
	-14°	+14°	.045"	.022"	490-92-2672	490-92-1672
<b>M</b>	-14°	+10°	.045"	.018"	490-21-2672	490-21-1672
	-14°	+10°	.045"	.022"	490-22-2672	490-22-1672
<b>S</b>	0°	0°	.045"	.018"	490-51-2672	490-51-1672
	0°	0°	.045"	.022"	490-52-2672	490-52-1672
1 pack (10 tubes)						

© 2018 Ortho Technology, Inc. TruFit is a trademark of Ortho Technology. Due to our ongoing efforts to update and improve our buccal tube designs, the product you receive may vary slightly from those depicted.

# TruFit™ 2.0

## Weldable Buccal Tubes



### Maxillary Triple Convertible Occlusal Headgear Tube

.018" x .025" Auxiliary Tube

	Slot Torque	Distal Offset	Headgear Tube	Slot Size	Weldable	
					Left	Right
<b>R</b>	-10°	+10°	.045"	.018"	490-11-2652	490-11-1652
	-10°	+10°	.045"	.022"	490-12-2652	490-12-1652
<b>R</b>	-14°	+14°	.045"	.018"	490-91-2652	490-91-1652
	-14°	+14°	.045"	.022"	490-92-2652	490-92-1652
<b>M</b>	-14°	+10°	.045"	.018"	490-21-2652	490-21-1652
	-14°	+10°	.045"	.022"	490-22-2652	490-22-1652
1 pack (10 tubes)						



### Maxillary Combination Non-Convertible Occlusal Headgear Tube

Occlusal Headgear Tube

	Slot Torque	Distal Offset	Headgear Tube	Slot Size	Weldable	
					Left	Right
<b>R</b>	-10°	+8°	.045"	.018"	490-11-2682	490-11-1682
	-10°	+8°	.045"	.022"	490-12-2682	490-12-1682
<b>M</b>	-14°	+10°	.045"	.018"	490-21-2682	490-21-1682
	-14°	+10°	.045"	.022"	490-22-2682	490-22-1682
<b>S</b>	0°	0°	.045"	.018"	490-51-2682	490-51-1682
	0°	0°	.045"	.022"	490-52-2682	490-52-1682
<b>S</b>	0°	+8°	.045"	.018"	490-41-2682	490-41-1682
	0°	+8°	.045"	.022"	490-42-2682	490-42-1682
1 pack (10 tubes)						

**R** The Ortho Technology version of the Roth Rx\*

**S** Standard Edgewise Rx

**M** The Ortho Technology version of the McLaughlin, Bennett, & Trevisi Rx\*



### Mandibular Lip Bumper Convertible

	Slot Torque	Distal Offset	Headgear Tube	Slot Size	Weldable	
					Left	Right
<b>R</b>	-25°	+4°	.045"	.018"	490-91-4691	490-91-3691
	-25°	+4°	.045"	.022"	490-92-4691	490-92-3691
1 pack (10 tubes)						



### Mandibular Single Convertible

	Slot Torque	Distal Offset	Headgear Tube	Slot Size	Weldable	
					Left	Right
<b>R</b>	-25°	+4°	-	.018"	490-91-4610	490-91-3610
	-25°	+4°	-	.022"	490-92-4610	490-92-3610
<b>M</b>	-20°	0°	-	.018"	490-21-4610	490-21-3610
	-20°	0°	-	.022"	490-22-4610	490-22-3610
1 pack (10 tubes)						



### Mandibular 1st or 2nd Molar Single Non-Convertible

	Slot Torque	Distal Offset	Headgear Tube	Slot Size	Weldable	
					Left	Right
<b>R</b>	-25°	+4°	-	.018"	490-91-4020	490-91-3020
	-25°	+4°	-	.022"	490-92-4020	490-92-3020
<b>M</b>	-10°	0°	-	.018"	490-21-4020	490-21-3020
	-10°	0°	-	.022"	490-22-4020	490-22-3020
<b>S</b>	0°	0°	-	.018"	490-51-4020	490-51-3020
	0°	0°	-	.022"	490-52-4020	490-52-3020
1 pack (10 tubes)						



### Mandibular Double Convertible

.018" x .025" Auxiliary Tube

	Slot Torque	Distal Offset	Headgear Tube	Slot Size	Weldable	
					Left	Right
<b>R</b>	-25°	+4°	-	.018"	490-91-4631	490-91-3631
	-25°	+4°	-	.022"	490-92-4631	490-92-3631
<b>M</b>	-20°	0°	-	.018"	490-21-4631	490-21-3631
	-20°	0°	-	.022"	490-22-4631	490-22-3631
1 pack (10 tubes)						



\*The Ortho Technology versions of these prescriptions are not implied to be an exact version of any other system, nor do we claim any endorsement of the respective doctors.



# TruFit™ 2.0

## Molar Bands

Available Loose or Prewelded  
with Our Free Prewelding Service

Molar Bands

- Rolled Edges**  
No sharp edges for maximum patient comfort
- Straight Interproximal Wall**  
Makes band seating easy
- Permanent Marking**  
For easy identification
- Micro-Etched Interior Surface**  
Ensures maximum retention  
**No Extra Charge!**

**MADE IN THE USA**



### Plain Molar Bands

Quadrant	1st Molars	2nd Molars
UR	495-00-1600-000	495-00-1700-000
UL	495-00-2600-000	495-00-2700-000
LR	495-00-3600-000	495-00-3700-000
LL	495-00-4600-000	495-00-4700-000
1 band		

### Precision Preweld Position Buccal Attachments to Molar Bands



Upper Molar

Entrance to buccal tube will bisect the mesial/buccal cusp



Lower Molar

### TruFit 2.0 Molar Band Features

- **Shaped for a Precise, Tight Fit on Every Tooth**  
Each band has precision shaped tooth anatomy for a tight secure fit with excellent retention.
- **Medium Temper Malleable Stainless Steel Finished to a Brilliant Mirror Luster**  
TruFit 2.0 stainless steel bands are strong enough to avoid wall collapses while being malleable enough for snap fittings that require little to no burnishing.
- **Laser Etched Exterior Identification System with Micro-Etched Interior**  
TruFit 2.0 bands display an exterior laser etched identification system for easy product selection. The interior is micro-etched to increase bond strength and retention.
- **Band Sizes Available From 29.5 to 44**  
See pages 66-67 for our band conversion chart.

### Lingual Cleat Attachments Centered on Molar Bands

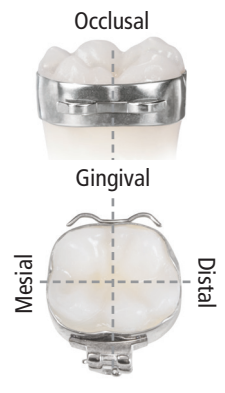
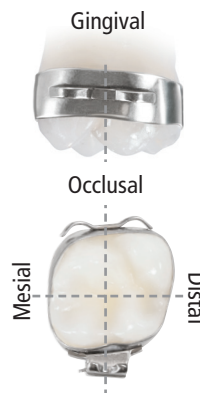



# Maxillary Prewelded Band and Tube Assemblies

Available With or Without Lingual Cleat

MADE IN THE USA



**Maxillary Single Convertible**

	Slot Torque	Distal Offset	Headgear Tube	Slot Size	With Lingual Cleat		Without Lingual Cleat	
					Left	Right	Left	Right
<b>R</b>	-10°	+10°	-	.018"	493-11-2610-000	493-11-1610-000	491-11-2610-000	491-11-1610-000
	-10°	+10°	-	.022"	493-12-2610-000	493-12-1610-000	491-12-2610-000	491-12-1610-000
<b>R</b>	-14°	+14°	-	.018"	493-91-2610-000	493-91-1610-000	491-91-2610-000	491-91-1610-000
	-14°	+14°	-	.022"	493-92-2610-000	493-92-1610-000	491-92-2610-000	491-92-1610-000
<b>M</b>	-14°	+10°	-	.018"	493-21-2610-000	493-21-1610-000	491-21-2610-000	491-21-1610-000
	-14°	+10°	-	.022"	493-22-2610-000	493-22-1610-000	491-22-2610-000	491-22-1610-000
Individual Assemblies								



**Maxillary Combination Convertible Occlusal Headgear Tube**

	Slot Torque	Distal Offset	Headgear Tube	Slot Size	With Lingual Cleat		Without Lingual Cleat	
					Left	Right	Left	Right
<b>R</b>	-10°	+10°	.045"	.018"	493-11-2672-000	493-11-1672-000	491-11-2672-000	491-11-1672-000
	-10°	+10°	.045"	.022"	493-12-2672-000	493-12-1672-000	491-12-2672-000	491-12-1672-000
<b>R</b>	-14°	+14°	.045"	.018"	493-91-2672-000	493-91-1672-000	491-91-2672-000	491-91-1672-000
	-14°	+14°	.045"	.022"	493-92-2672-000	493-92-1672-000	491-92-2672-000	491-92-1672-000
<b>M</b>	-14°	+10°	.045"	.018"	493-21-2672-000	493-21-1672-000	491-21-2672-000	491-21-1672-000
	-14°	+10°	.045"	.022"	493-22-2672-000	493-22-1672-000	491-22-2672-000	491-22-1672-000
<b>S</b>	0°	0°	.045"	.018"	493-51-2672-000	493-51-1672-000	491-51-2672-000	491-51-1672-000
	0°	0°	.045"	.022"	493-52-2672-000	493-52-1672-000	491-52-2672-000	491-52-1672-000
Individual Assemblies								



**Maxillary Combination Convertible Gingival Headgear Tube**

	Slot Torque	Distal Offset	Headgear Tube	Slot Size	With Lingual Cleat		Without Lingual Cleat	
					Left	Right	Left	Right
<b>R</b>	-10°	+10°	.045"	.018"	493-11-2671-000	493-11-1671-000	491-11-2671-000	491-11-1671-000
	-10°	+10°	.045"	.022"	493-12-2671-000	493-12-1671-000	491-12-2671-000	491-12-1671-000
<b>R</b>	-14°	+14°	.045"	.018"	493-91-2671-000	493-91-1671-000	491-91-2671-000	491-91-1671-000
	-14°	+14°	.045"	.022"	493-92-2671-000	493-92-1671-000	491-92-2671-000	491-92-1671-000
<b>M</b>	-14°	+10°	.045"	.018"	493-21-2671-000	493-21-1671-000	491-21-2671-000	491-21-1671-000
	-14°	+10°	.045"	.022"	493-22-2671-000	493-22-1671-000	491-22-2671-000	491-22-1671-000
Individual Assemblies								

**R** The Ortho Technology version of the Roth Rx\*

**M** The Ortho Technology version of the McLaughlin, Bennett, & Trevisi Rx\*

**S** Standard Edgewise Rx

\*The Ortho Technology versions of these prescriptions are not implied to be an exact version of any other system, nor do we claim any endorsement of the respective doctors.

© 2018 Ortho Technology, Inc. TruFit is a trademark of Ortho Technology. Sizes start at 29.5 up to 44. See band size conversion chart on pages 66-67 for specific details. Additional assemblies available. Custom orders also offered. Allow 3-4 weeks for delivery. †Lingual Sheaths are an additional cost. All bands are supplied with standard weld position unless custom ordered. Custom orders are final and cannot be returned. Due to our ongoing efforts to update and improve our buccal tube designs, the product you receive may vary slightly from those depicted.



Molar Bands



# TruFit™ 2.0

**Our Most Popular Assemblies are In-Stock and Ready for Same Day Shipment!**

Ask your Sales Representative about our Price-Lock Program



**Additional Assemblies Available**

MADE IN THE USA

## Maxillary Prewelded Band and Tube Assemblies

Available With or Without Lingual Cleat

Molar Bands



**Maxillary 1st Molar Single Non-Convertible**

	Slot Torque	Distal Offset	Headgear Tube	Slot Size	With Lingual Cleat		Without Lingual Cleat	
					Left	Right	Left	Right
<b>R</b>	-10°	+10°	-	.018"	493-11-2620-000	493-11-1620-000	491-11-2620-000	491-11-1620-000
	-10°	+10°	-	.022"	493-12-2620-000	493-12-1620-000	491-12-2620-000	491-12-1620-000
<b>R</b>	-14°	+14°	-	.018"	493-91-2620-000	493-91-1620-000	491-91-2620-000	491-91-1620-000
	-14°	+14°	-	.022"	493-92-2620-000	493-92-1620-000	491-92-2620-000	491-92-1620-000
<b>M</b>	-14°	+10°	-	.018"	493-21-2620-000	493-21-1620-000	491-21-2620-000	491-21-1620-000
	-14°	+10°	-	.022"	493-22-2620-000	493-22-1620-000	491-22-2620-000	491-22-1620-000
<b>S</b>	0°	0°	-	.018"	493-51-2620-000	493-51-1620-000	491-51-2620-000	491-51-1620-000
	0°	0°	-	.022"	493-52-2620-000	493-52-1620-000	491-52-2620-000	491-52-1620-000
Individual Assemblies								



**Maxillary 2nd Molar Single Non-Convertible**

	Slot Torque	Distal Offset	Headgear Tube	Slot Size	With Lingual Cleat		Without Lingual Cleat	
					Left	Right	Left	Right
<b>R</b>	-10°	+10°	-	.018"	493-11-2720-000	493-11-1720-000	491-11-2720-000	491-11-1720-000
	-10°	+10°	-	.022"	493-12-2720-000	493-12-1720-000	491-12-2720-000	491-12-1720-000
<b>R</b>	-14°	+14°	-	.018"	493-91-2720-000	493-91-1720-000	491-91-2720-000	491-91-1720-000
	-14°	+14°	-	.022"	493-92-2720-000	493-92-1720-000	491-92-2720-000	491-92-1720-000
<b>M</b>	-14°	+10°	-	.018"	493-21-2720-000	493-21-1720-000	491-21-2720-000	491-21-1720-000
	-14°	+10°	-	.022"	493-22-2720-000	493-22-1720-000	491-22-2720-000	491-22-1720-000
<b>S</b>	0°	0°	-	.018"	493-51-2720-000	493-51-1720-000	491-51-2720-000	491-51-1720-000
	0°	0°	-	.022"	493-52-2720-000	493-52-1720-000	491-52-2720-000	491-52-1720-000
Individual Assemblies								



**Maxillary Double Convertible**

.018" x .025" Auxiliary Tube

	Slot Torque	Distal Offset	Headgear Tube	Slot Size	With Lingual Cleat		Without Lingual Cleat	
					Left	Right	Left	Right
<b>R</b>	-10°	+10°	-	.018"	493-11-2631-000	493-11-1631-000	491-11-2631-000	491-11-1631-000
	-10°	+10°	-	.022"	493-12-2631-000	493-12-1631-000	491-12-2631-000	491-12-1631-000
<b>R</b>	-14°	+14°	-	.018"	493-91-2631-000	493-91-1631-000	491-91-2631-000	491-91-1631-000
	-14°	+14°	-	.022"	493-92-2631-000	493-92-1631-000	491-92-2631-000	491-92-1631-000
Individual Assemblies								



**Our Most Popular Assemblies are In-Stock and Ready for Same Day Shipment!**

**Additional Assemblies Available**



Ask your Sales Representative about our Price-Lock Program



## Maxillary Prewelded Band and Tube Assemblies

Available With or Without Lingual Cleat



**Maxillary Triple Convertible Occlusal Headgear Tube with Hook**

.018" x .025" Auxiliary Tube

	Slot Torque	Distal Offset	Headgear Tube	Slot Size	With Lingual Cleat		Without Lingual Cleat	
					Left	Right	Left	Right
<b>R</b>	-10°	+10°	.045"	.018"	493-11-2652-000	493-11-1652-000	491-11-2652-000	491-11-1652-000
	-10°	+10°	.045"	.022"	493-12-2652-000	493-12-1652-000	491-12-2652-000	491-12-1652-000
<b>R</b>	-14°	+14°	.045"	.018"	493-91-2652-000	493-91-1652-000	491-91-2652-000	491-91-1652-000
	-14°	+14°	.045"	.022"	493-92-2652-000	493-92-1652-000	491-92-2652-000	491-92-1652-000
<b>M</b>	-14°	+10°	.045"	.018"	493-21-2652-000	493-21-1652-000	491-21-2652-000	491-21-1652-000
	-14°	+10°	.045"	.022"	493-22-2652-000	493-22-1652-000	491-22-2652-000	491-22-1652-000
Cleat Individual Assemblies								

<b>R</b>	-10°	+10°	.045"	.018"	496-11-2652-000	496-11-1652-000	-	-
	-10°	+10°	.045"	.022"	496-12-2652-000	496-12-1652-000	-	-
With Lingual Sheath Individual Assemblies								



**Maxillary Combination Non-Convertible With Occlusal Headgear Tube**

	Slot Torque	Distal Offset	Headgear Tube	Slot Size	With Lingual Cleat		Without Lingual Cleat	
					Left	Right	Left	Right
<b>R</b>	-10°	+8°	.045"	.018"	493-11-2682-000	493-11-1682-000	491-11-2682-000	491-11-1682-000
	-10°	+8°	.045"	.022"	493-12-2682-000	493-12-1682-000	491-12-2682-000	491-12-1682-000
<b>M</b>	-14°	+10°	.045"	.018"	493-21-2682-000	493-21-1682-000	491-21-2682-000	491-21-1682-000
	-14°	+10°	.045"	.022"	493-22-2682-000	493-22-1682-000	491-22-2682-000	491-22-1682-000
<b>S</b>	0°	0°	.045"	.018"	493-51-2682-000	493-51-1682-000	491-51-2682-000	491-51-1682-000
	0°	0°	.045"	.022"	493-52-2682-000	493-52-1682-000	491-52-2682-000	491-52-1682-000
<b>S</b>	0°	+8°	.045"	.018"	493-41-2682-000	493-41-1682-000	491-41-2682-000	491-41-1682-000
	0°	+8°	.045"	.022"	493-42-2682-000	493-42-1682-000	491-42-2682-000	491-42-1682-000
Individual Assemblies								

**R** The Ortho Technology version of the Roth Rx\*

**M** The Ortho Technology version of the McLaughlin, Bennett, & Trevisi Rx\*

**S** Standard Edgewise Rx

\*The Ortho Technology versions of these prescriptions are not implied to be an exact version of any other system, nor do we claim any endorsement of the respective doctors.

© 2018 Ortho Technology, Inc. TruFit is a trademark of Ortho Technology. Sizes start at 29.5 up to 44. See band size conversion chart on pages 66-67 for specific details. Additional assemblies available. Custom orders also offered. Allow 3-4 weeks for delivery. †Lingual Sheaths are an additional cost. All bands are supplied with standard weld position unless custom ordered. Custom orders are final and cannot be returned. Due to our ongoing efforts to update and improve our buccal tube designs, the product you receive may vary slightly from those depicted.



## Mandibular Prewelded Band and Tube Assemblies

Available With or Without Lingual Cleat

MADE IN THE USA



**Mandibular 1st Molar Single Non-Convertible**

	Slot Torque	Distal Offset	Headgear Tube	Slot Size	With Lingual Cleat		Without Lingual Cleat	
					Left	Right	Left	Right
<b>R</b>	-25°	+4°	-	.018"	493-91-4620-000	493-91-3620-000	491-91-4620-000	491-91-3620-000
	-25°	+4°	-	.022"	493-92-4620-000	493-92-3620-000	491-92-4620-000	491-92-3620-000
<b>M</b>	-10°	0°	-	.018"	493-21-4620-000	493-21-3620-000	491-21-4620-000	491-21-3620-000
	-10°	0°	-	.022"	493-22-4620-000	493-22-3620-000	491-22-4620-000	491-22-3620-000
<b>S</b>	0°	0°	-	.018"	493-51-4620-000	493-51-3620-000	491-51-4620-000	491-51-3620-000
	0°	0°	-	.022"	493-52-4620-000	493-52-3620-000	491-52-4620-000	491-52-3620-000
Individual Assemblies								



**Mandibular 2nd Molar Single Non-Convertible**

	Slot Torque	Distal Offset	Headgear Tube	Slot Size	With Lingual Cleat		Without Lingual Cleat	
					Left	Right	Left	Right
<b>R</b>	-25°	+4°	-	.018"	493-91-4720-000	493-91-3720-000	491-91-4720-000	491-91-3720-000
	-25°	+4°	-	.022"	493-92-4720-000	493-92-3720-000	491-92-4720-000	491-92-3720-000
<b>M</b>	-10°	0°	-	.018"	493-21-4720-000	493-21-3720-000	491-21-4720-000	491-21-3720-000
	-10°	0°	-	.022"	493-22-4720-000	493-22-3720-000	491-22-4720-000	491-22-3720-000
<b>S</b>	0°	0°	-	.018"	493-51-4720-000	493-51-3720-000	491-51-4720-000	491-51-3720-000
	0°	0°	-	.022"	493-52-4720-000	493-52-3720-000	491-52-4720-000	491-52-3720-000
Individual Assemblies								



**Mandibular Single Convertible**

	Slot Torque	Distal Offset	Headgear Tube	Slot Size	With Lingual Cleat		Without Lingual Cleat	
					Left	Right	Left	Right
<b>R</b>	-25°	+4°	-	.018"	493-91-4610-000	493-91-3610-000	491-91-4610-000	491-91-3610-000
	-25°	+4°	-	.022"	493-92-4610-000	493-92-3610-000	491-92-4610-000	491-92-3610-000
<b>M</b>	-20°	0°	-	.018"	493-21-4610-000	493-21-3610-000	491-21-4610-000	491-21-3610-000
	-20°	0°	-	.022"	493-22-4610-000	493-22-3610-000	491-22-4610-000	491-22-3610-000
Individual Assemblies								



**Mandibular Double Convertible**  
.018" x .025" Auxiliary Tube

	Slot Torque	Distal Offset	Headgear Tube	Slot Size	With Lingual Cleat		Without Lingual Cleat	
					Left	Right	Left	Right
<b>R</b>	-25°	+4°	-	.018"	493-91-4631-000	493-91-3631-000	491-91-4631-000	491-91-3631-000
	-25°	+4°	-	.022"	493-92-4631-000	493-92-3631-000	491-92-4631-000	491-92-3631-000
<b>M</b>	-20°	0°	-	.018"	493-21-4631-000	493-21-3631-000	491-21-4631-000	491-21-3631-000
	-20°	0°	-	.022"	493-22-4631-000	493-22-3631-000	491-22-4631-000	491-22-3631-000
Individual Assemblies								



**Mandibular Lip Bumper Convertible**

	Slot Torque	Distal Offset	Lip Bumper	Slot Size	With Lingual Cleat		Without Lingual Cleat	
					Left	Right	Left	Right
<b>R</b>	-25°	+4°	.045"	.018"	493-91-4691-000	493-91-3691-000	491-91-4691-000	491-91-3691-000
	-25°	+4°	.045"	.022"	493-92-4691-000	493-92-3691-000	491-92-4691-000	491-92-3691-000
Individual Assemblies								

# TruFit™ 2.0

We've Pre-Selected the Most Popular Sizes with the Most Popular Buccal Tubes to Get You Started!

## Assembly Starter Kits

Ask your Sales Representative for Details



MADE IN THE USA



**Maxillary Single Convertible with Lingual Cleats**

	Slot Torque	Distal Offset	Headgear Tube	Slot Size	Starter Kit
<b>R</b>	-10°	+10°	-	.018"	493-11-1910-080
	-10°	+10°	-	.022"	493-12-1910-080
<b>M</b>	-14°	+10°	-	.018"	493-21-1910-080
	-14°	+10°	-	.022"	493-22-1910-080
1 kit (80 assemblies)					



**Maxillary Combination Convertible with Lingual Cleats**

	Slot Torque	Distal Offset	Headgear Tube	Slot Size	Starter Kit
<b>R</b>	-10°	+10°	.045"	.018"	493-11-1970-080
	-10°	+10°	.045"	.022"	493-12-1970-080
<b>M</b>	-14°	+10°	.045"	.018"	493-21-1970-080
	-14°	+10°	.045"	.022"	493-22-1970-080
1 kit (80 assemblies)					



**Mandibular Single Convertible with Lingual Cleats**

	Slot Torque	Distal Offset	Headgear Tube	Slot Size	Starter Kit
<b>R</b>	-25°	+4°	-	.018"	493-11-1010-080
	-25°	+4°	-	.022"	493-12-1010-080
<b>M</b>	-20°	0°	-	.018"	493-21-1010-080
	-20°	0°	-	.022"	493-22-1010-080
1 kit (80 assemblies)					

**R** The Ortho Technology version of the Roth Rx\* **M** The Ortho Technology version of the McLaughlin, Bennett, & Trevisi Rx\*

\*The Ortho Technology versions of these prescriptions are not implied to be an exact version of any other system, nor do we claim any endorsement of the respective doctors.



Each Starter Kit Includes 40 Left and 40 Right Assemblies

**TruFit™ 2.0 Band and Tube Assembly Starter Kits**  
Includes: 40 left and 40 right band & tube assemblies with lingual cleats, 2x band tray organizers dimensions 11 1/4" W x 1 1/2" H x 8 1/4" D

• 2 Stackable Band Organizers included with your purchase

Starter Kits Included	34.5	35	35.5	36	36.5	37	37.5	38	38.5	39	39.5	40
Left Side	2	2	2	4	4	5	5	5	4	3	2	2
Right Side	2	2	2	4	4	5	5	5	4	3	2	2

Bands Sizes are Available From 29.5 to 44

**BAND SIZE CONVERSION TRAYS**  
Included With Your Order

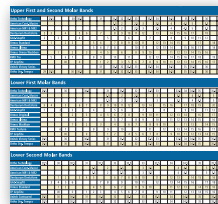

Ask Your Account Representative For Details

© 2018 Ortho Technology, Inc. TruFit is a trademark of Ortho Technology. Due to our ongoing efforts to update and improve our buccal tube designs, the product you receive may vary slightly from those depicted.

## Converting to Ortho Technology's TruFit™ 2.0 Molar Bands is Easy!



### No Need to Learn New Band Sizes

When you convert to TruFit™ 2.0

Regardless of the brand being currently used in your practice when you convert to TruFit 2.0, we will label our band trays with your current sizing, eliminating the need to learn our sizes and leaving your workflow unchanged.

**BAND SIZE  
CONVERSION TRAYS  
INCLUDED WITH  
YOUR ORDER**

*Ask Your Sales Representative for Details*

### Upper First and Second Molar Band Sizes

Ortho Technology		29.5	30	30.5	31	31.5	32	32.5	33	33.5	34	34.5	35	35.5	36	36.5									
American MR Full Sizes		1	2	3	5	6	7	8	9	10	11	12	13	14	15	17	18	19							
American MR 1/2 Sizes						1.5	2		2.5	3		3.5	4	4.5	5	5.5	6								
Dentaurum Dentaform		2	3	4	5	6	7	8	9	10	11	12	13	14	15	16	17	18	19	20					
GAC-SnapFit			1	2		3	4	5	6		7	8	9	10	11	12	13		14						
Ormco			1	2	3		4	5	6	7	8	9	10		11	12	13	14	15	16	17	18	19		
RMO Truform		1	2	3	4	5	6		7		8		9	10	11	12		13		14	15	16	17	18	
TP GripTite				00	0		1	2		3	5	6	7	8	9	10	11	12	13	14	15	16	17	18	19
Unitek Victory Series		29.5	30	30.5	31	31.5	32	32.5	33	33.5	34	34.5	35	35.5	36		36.5								

### Lower First Molar Band Sizes

Ortho Technology		29.5	30	30.5	31	31.5	32	32.5	33	33.5	34	34.5	35	35.5	36									
American MR Full Sizes			1	2	3	4	5	6	7	8	9	10	11	12	13	14	16	17	18					
American MR 1/2 Sizes						1.5	2	2.5		3		3.5		4	4.5	5								
Dentaurum Dentaform			3	4	5	6	7	8	9	10	11	12	13	14	15	16	17	18	19	20	21	22		
GAC-SnapFit			1			2		3	4	5	6		7	8	9	10	11	12	13					
Ormco			1					5	6	7	8	9	10	11	12	13	14	15	16	17	18			
RMO Truform		1	2	3	4	5		6	7		8	9	10		11	12	13	14	15	16	17			
TP GripTite					00	0	1	2		4	5	6	7	8	9	10	11	12	13	14	15	16	17	18
Unitek Victory Series		29.5	30	30.5	31	31.5	32	32.5	33	33.5	34	34.5	35	35.5	36									

### Lower Second Molar Band Sizes

Ortho Technology		29.5	30	30.5	31	31.5	32	32.5	33	33.5	34	34.5	35	35.5	36	36.5	37									
American MR Full Sizes			1	2		4	5	6	7	8	9	10		11	12	13	14	15	16	17	18	19	20			
American MR 1/2 Sizes						1.5	2	2.5		3	3.5		4	4.5		5	5.5	6	6.5	7	7.5					
Dentaurum Dentaform			1	2	3	4	5	6	7	8	9	10	11	12	13	14	15	16	17	18	19	20				
GAC-SnapFit		1	2	3	4		5	6	7	8	9	10	11	12	13	14	15	16	17	18	19	20	21			
Ormco			1	2	3	4	5	6	7	8	9	10	11	12	13	14	15	16	17	18	19	20				
RMO Truform						7	8	9	10	11		12	13		14	15	16	17		18	19	20				
TP GripTite				00	0	1	2	3	4	5	6	7	8	9	10	11	12	13	14	15	16	17	18	19	20	21
Unitek Victory Series		29.5	30	30.5	31	31.5	32	32.5	33	33.5	34	34.5	35	35.5	36	36.5	37									

This band conversion chart is for general reference only. Band sizing varies from company to company and may change periodically. Exact accuracy of this data is not expressed, implied or guaranteed by Ortho Technology.

# MOLAR BANDS



**TruFit™ 2.0 Molar Bands**  
See page 60

Ask your Sales Representative for details



## Upper First and Second Molar Band Sizes

Ortho Technology	37	37.5			38	38.5	39	39.5		40	40.5	41	41.5	42	42.5	43	43.5	44					
American MR Full Sizes		20	21	22	23	24	25		27	28		29	30	31		32							
American MR 1/2 Sizes	6.5	7			7.5	8	9		9.5	10	10.5	11	11.5		12	12.5	13	13.5					
Dentaurem Dentaform	21	22	23	24	25	26	27	28	29	30		31	32										
GAC-SnapFit	15	16		17	18	19	20		21	22		23	24	25		26	27		28	29			
Ormco	20	21			22	23	24		25	26		27	28	29	30		31		32				
RMO Truform		19	20		21	22	23	24	25	26	27	28		29	30	31	32		33	34	35	36	
TP GripTite	20	21	22		23	24	25	26		27		29	30	31		32	33	34		35	36		
Unitek Victory Series	37	37.5			38	38.5	39	39.5		40	40.5	41	41.5	42	42.5	43	43.5	44					

## Lower First Molar Band Sizes

Ortho Technology		36.5	37	37.5	38	38.5	39	39.5	40	40.5	41	41.5	42	42.5	43	43.5	44						
American MR Full Sizes	19		20	21	22	23	24	25	26		27	28	29		30	31		32					
American MR 1/2 Sizes	6	6.5	7		7.5		8		8.5		9	9.5	10.5	11	11.5		12	12.5	13	13.5			
Dentaurem Dentaform	23		24	25	26	27	28	29	30		31	32											
GAC-SnapFit	14	15		16	17	18		19	20	21	22		23	24	25	26	27		28		29	30	31
Ormco	19		20		21	22	23	24	25	26	27	28	29	30	31	32							
RMO Truform	18		19		20	21	22	23	24	25	26	27	28	29	30	31	32	33	34	35	36		
TP GripTite	19	20	21		22	23	24	25	27	28		29	30	31		32	33	34		35	36		
Unitek Victory Series		36.5	37	37.5	38	38.5	39	39.5	40	40.5	41	41.5	42	42.5	43	43.5	44						

## Lower Second Molar Band Sizes

Ortho Technology		37.5	38	38.5	39			39.5	40	40.5	41	41.5	42										
American MR Full Sizes		21	22	23	24	25	26	27		28	29	30											
American MR 1/2 Sizes			8				8.5	9	9.5	10		10.5	11										
Dentaurem Dentaform		21	22	23	24	25	26	27		28	29												
GAC-SnapFit		22		23		24		25	26	27		28	29	30									
Ormco		21	22		23	24	25		26	27	28		29	30	31	32							
RMO Truform		21	22		23	24	25	26	27		28	29	30	31	32								
TP GripTite		22		23	24	25	26	27	28		29		30	31	32	33	34	35					
Unitek Victory Series		37.5	38	38.5	39			39.5	40	40.5	41												



Molar Bands



## Prewelded Lingual Attachments for TruFit 2.0 Molar Bands

MADE IN THE USA



### Prewelded Cleat

Molar ..... 494-025  
Cuspid/Bicuspid... 494-024  
1 per pack



### Prewelded Lug Molar

Item #: 494-028  
Length 4.8 mm  
1 per pack



### Prewelded Indented Lingual Sheath with Hook

UR/LL ..... 494-038  
UL/LR ..... 494-039  
1 per pack



### Prewelded Indented Lingual Sheath

Item #: 494-032  
1 per pack



### Prewelded Button Oval

Oval Flat ..... 494-020  
Oval Curved.... 494-021  
1 per pack



### Weldable Lingual Cleat

A. Molar ..... 494-025-10  
B. Cuspid/Bicuspid.... 494-024-10  
10 per pack



### Direct Bond Lingual Cleat

Item #: 494-004-10  
Micro-etched  
10 per pack



### Indented Lingual Sheath with Ball Hook

UR/LL ..... 494-038-10  
UL/LR ..... 494-039-10  
10 per pack



### Indented Lingual Sheath

Indent provides additional retention to hold palatal arch bar in sheath.  
Item #: 494-032-10  
10 per pack

## Bondable Attachments Loose

MADE IN THE USA



### Direct Bond Eyelets Round Base

Item #: 025-100  
3.5 mm diameter two piece flat base  
10 per pack



### Direct Bond Eyelets Rectangle Base

Item #: 025-000  
3.75 mm x 3.0 mm one piece curved base  
10 per pack



### Direct Bond Buttons Round Base

Item #: 494-001-10  
Micro-etched  
3.5 mm diameter curved one piece base  
10 per pack



### Direct Bond Buttons Rectangle Base

A. Oval Flat..... 400-201  
B. Oval Curved..... 400-202  
3.88 mm x 2.48 mm one piece base  
10 per pack



# Easy Online Ordering

[www.orthotechnology.com](http://www.orthotechnology.com)

**New Site. New Style.**  
Same Exceptional  
Customer Service.



**Responsive. Streamlined.**  
Place Orders with Ease.

Bicuspid Bands

## Store and Organize Brackets, and Band Assemblies!



MADE IN THE USA

### Stackable Organizer

- Modular interlocking design
- Clearly marked trays for quick product selection
- Constructed with high quality durable plastic

Band Organizer..... 85180K  
Bracket Organizer ..... 85181K  
*Includes: band/bracket tray*  
*Organizer dimensions*  
*11 1/4" W x 1 1/2" H x 8 1/4" D*

### Molar Band Trays

**UR 1<sup>st</sup>/2<sup>nd</sup> Molar Band Tray**  
Item #: 4002-05

**UL 1<sup>st</sup>/2<sup>nd</sup> Molar Band Tray**  
Item #: 4002-06

**LR 1<sup>st</sup>/2<sup>nd</sup> Molar Band Tray**  
Item #: 4002-07

**LL 1<sup>st</sup>/2<sup>nd</sup> Molar Band Tray**  
Item #: 4002-08

*1 tray per pack*

*Tray included with any first time kit orders.*



## Lotus Plus DS Self-Ligating Bondable Buccal Tubes

### An Advanced Buccal Tube

The innovative Lotus Plus DS Self-Ligating Buccal Tubes offer passive or interactive ligation and feature unique maxillary and mandibular designs with anatomical mesh pads for maximum bond strength and fit.

**Low Profile Hook**  
For patient comfort

**Positioning Notch**  
To assist with placement and avoid interference

**Low Profile Design**  
To reduce occlusal interference and provide maximum patient comfort

**Mesh Pad with Defined Buccal Indent**  
For a precise contoured fit



**PASSIVE**  
Upper Right



**INTERACTIVE**  
Lower Right

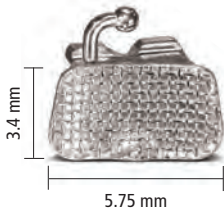
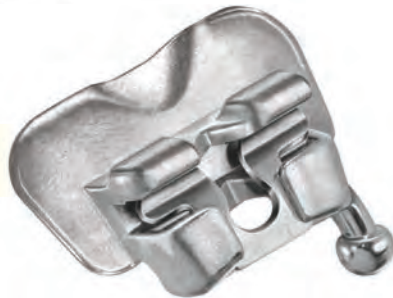

**Mesially Extended Bonding Pad**  
For a secure fit



- Self-Ligating Nickel Titanium Clip for easy wire placement
- No need to re-tie previously converted tubes
- Flexible clips help eliminate step bends
- Contoured, mesially extended base for an accurate, precise fit
- Positioning notches for quick alignment

1 pack (10 tubes)



**A COMPLETE SL SYSTEM WITH OUR**

**Lotus Plus DS Self-Ligating Brackets**

See page 16



### Passive

	Quadrant	Torq.	Ang.	Offset	.022" Slot
<b>R</b>	Upper Right	-10°	0°	+8°	300-12-1020
	Upper Left	-10°	0°	+8°	300-12-2620
<b>R</b>	Lower Right	-25°	0°	+5°	300-12-3620
	Lower Left	-25°	0°	+5°	300-12-4620
<b>D</b>	Upper Right	-18°	0°	+12°	300-32-1020
	Upper Left	-18°	0°	+12°	300-32-2620
<b>D</b>	Lower Right	-28°	+2°	+2°	300-32-3620
	Lower Left	-28°	+2°	+2°	300-32-4620

**R** The Ortho Technology version of the Roth Rx\*

**D** The Ortho Technology version of the Damon Rx\*

### Interactive

	Quadrant	Torq.	Ang.	Offset	.022" Slot
<b>R</b>	Upper Right	-10°	0°	+8°	301-12-1020
	Upper Left	-10°	0°	+8°	301-12-2620
<b>R</b>	Lower Right	-25°	0°	+5°	301-12-3620
	Lower Left	-25°	0°	+5°	301-12-4620
<b>D</b>	Upper Right	-18°	0°	+12°	301-32-1020
	Upper Left	-18°	0°	+12°	301-32-2620
<b>D</b>	Lower Right	-28°	+2°	+2°	301-32-3620
	Lower Left	-28°	+2°	+2°	301-32-4620

\*The Ortho Technology versions of the Roth and Damon prescriptions are not implied to be an exact version of any other system, nor do we claim any endorsement of the respective doctors.

# TruEase™ Bondable Buccal Tubes



Designed With the Latest Technology  
for Patient Comfort

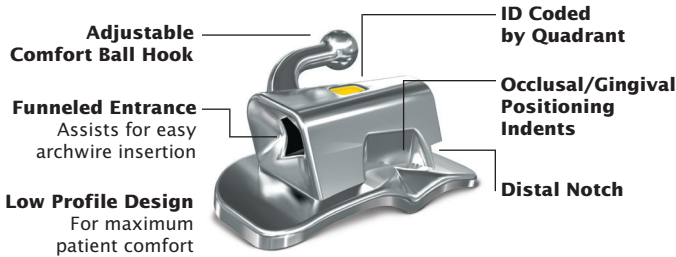

- **Stainless Steel Construction**
- **Molded Compound Contour Base with 80 Gauge Indented Mesh Pad** provides an anatomically correct fit that conforms to the tooth ensuring maximum bond strength
- **The Indented Pad** assists in easy and accurate placement to conform into the buccal groove
- **The Extended Base** provides maximum coverage for greater bond strength and control
- **4.2 mm Mesial/Distal Dimension** for full rotational control

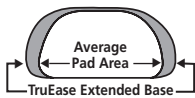

## Single Non-Convertible

Quadrant	Slot Torque	Distal Offset	Color Code	Extended Base Slot Size	
				.018"	.022"
<b>R</b> Upper Right	-10°	8°	●	460-11-1020	460-12-1020
Upper Left	-10°	8°	●	460-11-2020	460-12-2020
<b>R</b> Lower Right	-25°	5°	■	460-11-3020	460-12-3020
Lower Left	-25°	5°	■	460-11-4020	460-12-4020
<b>M</b> Upper Right	-14°	10°	●	460-21-1020	460-22-1020
Upper Left	-14°	10°	●	460-21-2020	460-22-2020
<b>M</b> Lower Right	-20°	0°	▲	460-21-3020	460-22-3020
Lower Left	-20°	0°	▲	460-21-4020	460-22-4020
<b>S</b> UR/LL	0°	0°	◆	460-51-7020	460-52-7020
UL/LR	0°	0°	◆	460-51-8020	460-52-8020
1 pack (10 tubes)					

**R** The Ortho Technology version of the Roth Rx\*

**M** The Ortho Technology version of the McLaughlin, Bennett, & Trevisi Rx\*

**S** Standard Edgewise Rx

## TruEase™ Low Profile Mini Bondable Buccal Tubes



Specifically Designed for Partially  
Erupted Second Molars

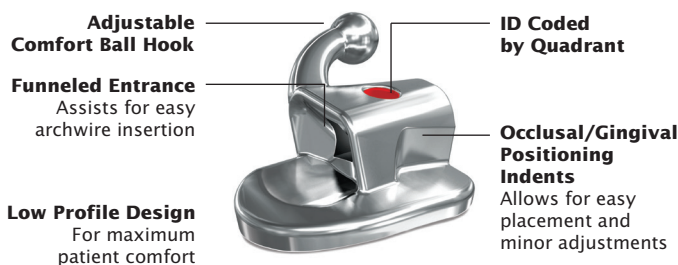

- **Stainless Steel Construction**
- **Mesially Placed Compound Contour Base** is designed to fit easily and precisely on the second molar mesial cusp to provide an anatomically correct fit
- **Pylon Base** with Electrical Discharge Machining (EDM) offers retention superior to mesh bonding pads
- **Torque in Base** allows easier alignment for optimal functional occlusion and case finishing
- **2.5 mm Mesial/Distal Dimension**



Quadrant	Slot Torque	Distal Offset	Color Code	Slot Size	
				.018"	.022"
<b>R</b> Upper Right	-10°	0°	●	470-11-1720	470-12-1720
Upper Left	-10°	0°	●	470-11-2720	470-12-2720
<b>R</b> Lower Right	-25°	0°	■	470-11-3720	470-12-3720
Lower Left	-25°	0°	■	470-11-4720	470-12-4720
<b>M</b> UR/LL	-14°	0°	●	470-21-7723	470-22-7723
UL/LR	-14°	0°	●	470-21-8723	470-22-8723
<b>S</b> UR/LL	0°	0°	◆	470-51-7720	470-52-7720
UL/LR	0°	0°	◆	470-51-8720	470-52-8720
1 pack (10 tubes)					

**R** The Ortho Technology version of the Roth Rx\*

**M** The Ortho Technology version of the McLaughlin, Bennett, & Trevisi Rx\*

**S** Standard Edgewise Rx

\*The Ortho Technology versions of these prescriptions are not implied to be an exact version of any other system, nor do we claim any endorsement of the respective doctors.

© 2018 Ortho Technology, Inc. TruEase is a trademark of Ortho Technology.



### TruEase Buccal Tubes Mini Typodont

Item #: G50-000

Includes: 1x TruEase Buccal Tube  
and 1x TruEase Low Profile Mini  
Buccal Tube

# Votion® Bondable Buccal Tubes



## Integrated Appliance System Designed to Work Seamlessly with Votion Brackets

The Votion Buccal Tube is a single non-convertible tube designed with modern features for practitioners' and patients' needs. Placement and positioning are made easy with side positioning indents, a defined buccal indent, and a compound contour base. Patients benefit from a smooth, low-profile rounded shape, and lowered hook for arguably the most comfortable treatment experience.

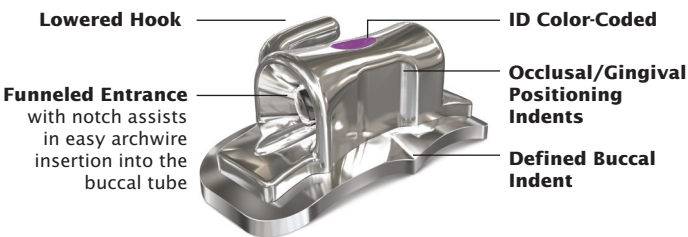

- **80-Gauge Micro-Etched Mesh Pad** ensures maximum bond strength
- **Metal Injection Molding (MIM) Stainless Steel**
- **Low Profile** for maximum patient comfort
- **Occlusal/Gingival Positioning Indents** for easy placement and minor adjustments
- **Smooth Rounded Surfaces and Lowered Hook** position and orientation for improved patient comfort
- **Defined Buccal Indent and Compound Contoured Base** for ease of placement and anatomical fit that conforms to the tooth

## Single Non-Convertible

Quadrant	Slot Torque	Distal Offset	Color Code	Extended Base Slot Size	
				.018"	.022"
<b>R</b> Upper Right	-14°	14°		351-11-1620	351-12-1620
Upper Left	-14°	14°		351-11-2620	351-12-2620
<b>R</b> Lower Right	-25°	4°		351-11-3620	351-12-3620
Lower Left	-25°	4°		351-11-4620	351-12-4620
<b>M</b> Upper Right	-14°	10°		351-21-1620	351-22-1620
Upper Left	-14°	10°		351-21-2620	351-22-2620
<b>M</b> Lower Right	-20°	0°		351-21-3620	351-22-3620
Lower Left	-20°	0°		351-21-4620	351-22-4620
1 pack (10 tubes)					

**R** The Ortho Technology version of the Roth Rx\*

**M** The Ortho Technology version of the McLaughlin, Bennett, & Trevisi Rx\*



**SEAMLESS INTEGRATION WITH OUR...  
Votion® Stainless Steel Bracket System**

See pages 40-42

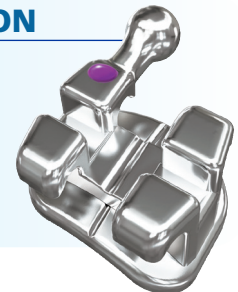

Buccal Tubes

## Votion® Mini Bondable Buccal Tubes

### Specifically Designed for the Most Comfortable Treatment

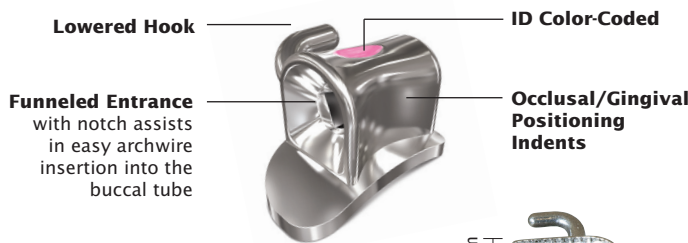

Quadrant	Slot Torque	Distal Offset	Color Code	Slot Size	
				.018"	.022"
<b>R</b> Upper Right	-10°	0°		352-11-1620	352-12-1620
Upper Left	-10°	0°		352-11-2620	352-12-2620
<b>R</b> Lower Right	-25°	0°		352-11-3620	352-12-3620
Lower Left	-25°	0°		352-11-4620	352-12-4620
<b>M</b> Upper Right	-14°	10°		352-21-1620	352-22-1620
Upper Left	-14°	10°		352-21-2620	352-22-2620
<b>M</b> Lower Right	-10°	0°		352-21-3620	352-22-3620
Lower Left	-10°	0°		352-21-4620	352-22-4620
1 pack (10 tubes)					

**R** The Ortho Technology version of the Roth Rx\*

**M** The Ortho Technology version of the McLaughlin, Bennett, & Trevisi Rx\*

\*The Ortho Technology versions of these prescriptions are not implied to be an exact version of any other system, nor do we claim any endorsement of the respective doctors.

© 2018 Ortho Technology, Inc. Votion is a registered trademark of Ortho Technology.

# BUCCAL TUBES



**Lower Profile Design**  
To reduce occlusal interference

**Positioning Notch**  
To assist with placement and avoid interference

**Removable Color Coded Identification**  
Marked for quick and accurate placement. Red upper and yellow lower

**Low Profile Hook**  
For patient comfort



**Indented Mesh Pad**  
For a precise contoured fit

**Mesial/ Distal Dimension**  
3.6 mm

**Chamfered Entry**  
Guides wires into buccal tube



## Single Non-Convertible - Bondable

Quadrant	Slot Torque	Distal Offset	Slot Size .018"	Slot Size .022"
<b>R</b> Upper Right	-10°	+8°	204B-825	204B-225
Upper Left	-10°	+8°	204B-826	204B-226
<b>R</b> Lower Right	-25°	+5°	204B-827	204B-227
Lower Left	-25°	+5°	204B-828	204B-228
<b>M</b> Upper Right	-14°	+10°	204B-833	204B-233
Upper Left	-14°	+10°	204B-834	204B-234
<b>M</b> Upper Right	-10°	0°	204B-831U	204B-231U
Upper Left	-10°	0°	204B-832U	204B-232U
<b>M</b> Lower Right	-10°	0°	204B-831L	204B-231L
Lower Left	-10°	0°	204B-832L	204B-232L
<b>S</b> Upper Right	0°	0°	204B-821U	204B-221U
Upper Left	0°	0°	204B-822U	204B-222U
<b>S</b> Lower Right	0°	0°	204B-821L	204B-221L
Lower Left	0°	0°	204B-822L	204B-222L

**R** The Ortho Technology version of the Roth Rx\* **M** The Ortho Technology version of the McLaughlin, Bennett, & Trevisi Rx\* **S** Standard Edgewise Rx

\*The Ortho Technology versions of these prescriptions are not implied to be an exact version of any other system, nor do we claim any endorsement of the respective doctors.

## TruCast™ Low Profile Bondable Buccal Tubes

### Maximum Bond Strength with a Comfortable Anatomical Fit

- Color coded scribe line for height and angulation reference point, Red = Upper, Yellow = Lower
- Indented 80 gauge mesh pad for an anatomical fit and maximum bond strength
- Occlusal and gingival positioning notches for ease of placement and handling

1 pack (10 tubes)

Buccal Tubes

© 2018 Ortho Technology, Inc. TruCast is a trademark of Ortho Technology.

**Lower Profile Design**  
To reduce occlusal interference

**Positioning Notch**  
To assist with placement and avoid interference

**Low Profile Hook**  
For patient comfort



**Mesially Extended Bonding Pad**  
For a secure fit

**Parallel Tube Design**  
For secure tube pick-up and placement

**Mesial/ Distal Dimension**  
2.4 mm

**Chamfered Entry**  
Guides wires into buccal tube



MADE IN THE USA

## TruCast™ Mini Second Molar Bondable Buccal Tubes

### Allows for Earlier Treatment of Partially Erupted Second Molars

Quadrant	Slot Torque	Distal Offset	Slot Size .018"	Slot Size .022"
Lower Right	-25°	0°	304B-833	304B-233
Lower Left	-25°	0°	304B-834	304B-234
Upper Right	-10°	0°	304B-831	304B-231
Upper Left	-10°	0°	304B-832	304B-232
UL/LR	0°	0°	304B-822	304B-222
UR/LL	0°	0°	304B-821	304B-221

- Smooth, compact design for patient comfort
- Chamfered archwire entry point for easy wire placement
- Contoured, mesially extended base for an accurate, precise fit
- Low profile hook is adjustable for patient comfort
- Positioning notch for quick alignment
- Parallel design for secure tube pick-up and placement
- Bondable and weldable

1 pack (10 tubes)